

OPERATING INSTRUCTIONS

7.0" 16:9 Color Monitor

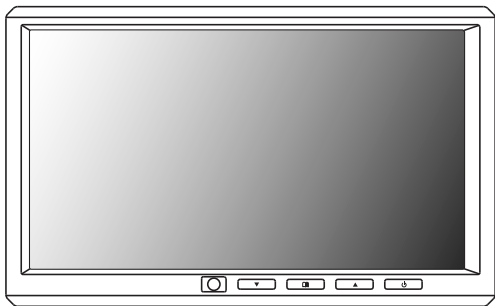

Important Notice

It is unlawful in most jurisdictions for a person to drive a motor vehicle which is equipped with a television or screen that is located in the motor vehicle at any point forward of the back of the driver's seat, or that is visible directly or indirectly to the driver while operating the vehicle.

CAUTION

1. Do not expose to direct sunlight for extended periods of time.
2. Do not drop the monitor or expose to strong impacts.
3. Keep the monitor clean and dry.
4. Do not operate the monitor at temperatures below -4°F (-20°C) or above 176°F (80°C).

Pedestal Mounting:

The pedestal mount features an adjustable viewing angle.

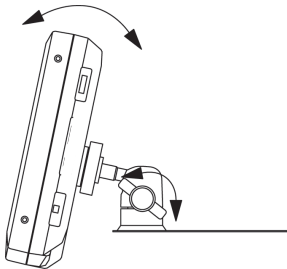

To install the pedestal mount:

1. Select appropriate locations in your vehicle for the pedestal and for the power supply module.
2. Test fit the mounting pedestal foot in the desired location:
Be sure that the monitor will be able to slide onto the pedestal without interference after the pedestal has been installed.
Be sure that the mounting location can accommodate screws safely. Never screw into any surface without first inspecting behind and below it.
3. Ensure that the interconnect cables will reach from the monitor location to the power supply module. Relocate the power supply module if needed.
4. If the mounting surface is not perfectly flat, bend the flanges on the mounting foot for the best fit without yet removing the backing from the flange's double-sided tape.
5. Remove the tape backing and press the pedestal into place.

Pedestal Mounting:

6. Screw the pedestal into place with the mounting screws provided.
7. Slide the monitor onto the pedestal as shown, and tighten the adjustment knob. Adjust viewing angle as needed.

Mounting Stand

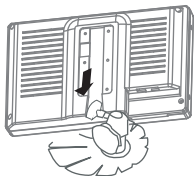

Step1.

Slide Monitor into optional mounting stand

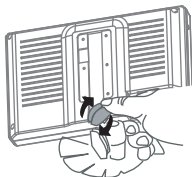

Step2.

Secure "Height" position by adjusting Knob



Step3.

Secure "Tilt" position by adjusting knob

Electrical Connections:

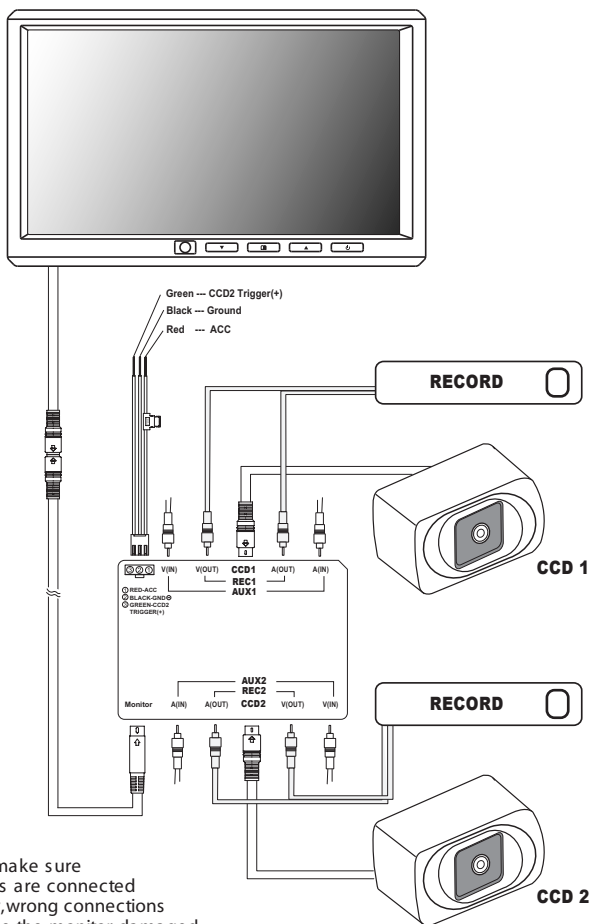

Noted:

Please make sure all cables are connected correctly, wrong connections will cause the monitor damaged.

Default for reverse gear operation

Basic Operation:

Front Control Panel:

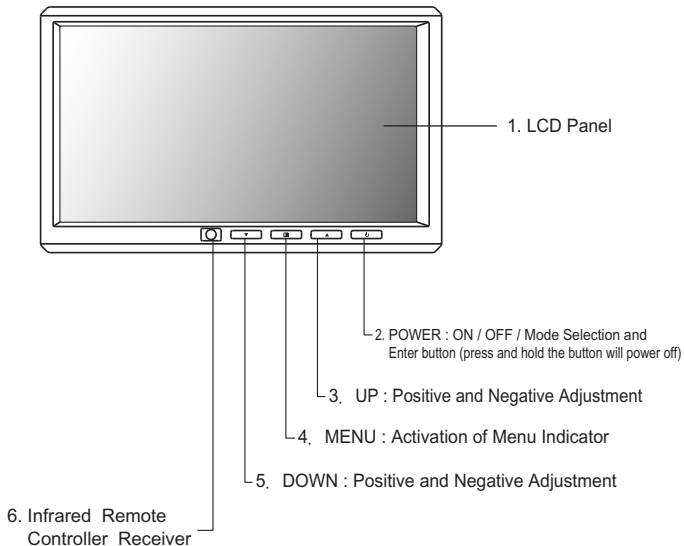

Basic Operation:

Remote Control:

The remote control includes the following buttons for use with this monitor:
Monitor Menu, Mode, Up, Down, Left, Right and Power.

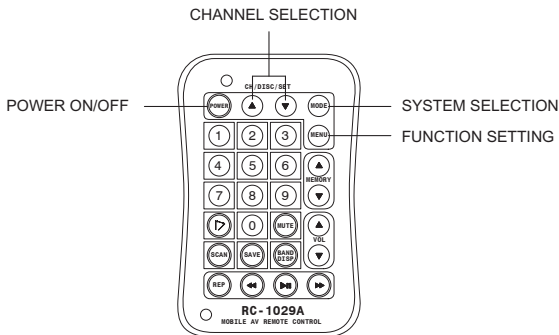

* ONLY WORK ON IN-DASH WIDE SCREEN COLOR MONITOR

Replacement of Battery:

1. Use a small coin to pry open battery holder from compartment.
2. Remove old battery and put in a new one with positive sign " + " facing upward.
3. Push compartment into position.

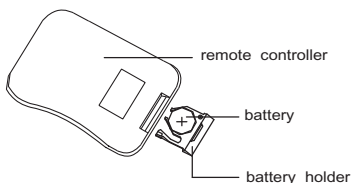

Precaution :

1. Dispose off used battery properly.
2. Do not misuse battery by short - circuiting the " + " and " - " terminal or put it into fire.
3. Remove used battery from compartment to prevent leakage from damaged battery.
4. To avoid accident , prevent children from playing with the battery.

On-Screen-Display Settings:

MODE:

When monitor is power on, press mode button on remote or power button control panel to select video inputs AUX1/AUX2. (Press and hold power button on control panel will power off the monitor.)

MONITOR SETTINGS:

Press the Menu button on the remote or front control panel, the OSD menu will show the LCD screen as below, use the up/down buttons on remote or up/down buttons on front control panel to select setting .

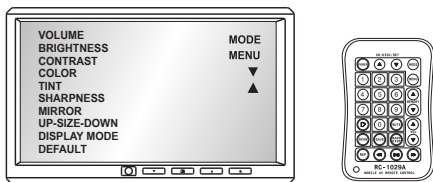

VOLUME:

Press Menu button on remote or on control panel, OSD menu will show on LCD screen as below (left chart), press up/down button on remote or up/down button on control panel to select "VOLUME" setting, "VOLUME" setting will show as below (right chart).

※In general, press ▲ or ▼ keys on control panel can be control volume directly.

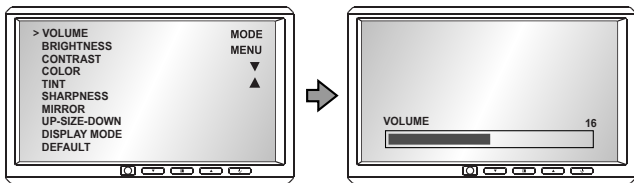

BRIGHTNESS:

Press Menu button on remote or on control panel, OSD menu will show on LCD screen as below (left chart) , press enter button on remote or power button on control panel to select "BRIGHTNESS" setting, "BRIGHTNESS" setting will show as below (right chart).

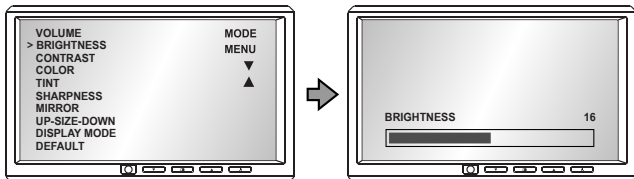

On-Screen-Display Settings:

CONTRAST:

Press Menu button on remote or on control panel, OSD menu will show on LCD screen as below (left chart), press up/down button on remote or press up/down button on control panel to select "CONTRAST" setting. "CONTRAST" setting will show as below (right chart).

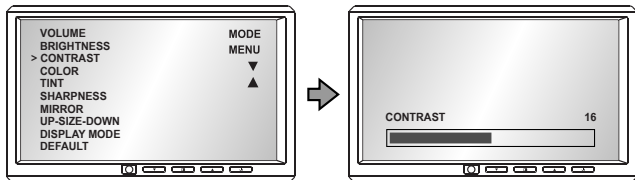

COLOR:

Press Menu button on remote or on control panel, OSD menu will show on LCD screen as below (left chart), press up/down button on remote or press up/down button on control panel to select "COLOR" setting, "COLOR" setting will show as below (right chart).

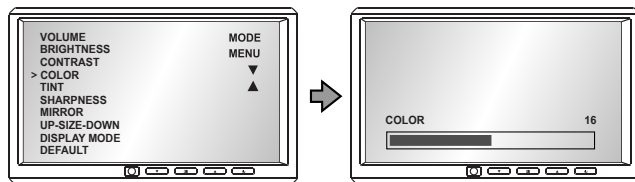

TINT:

Press Menu button on remote or on control panel, OSD menu will show on LCD screen as below (left chart), press up/down button on remote or press up/down button on control panel to select "TINT" setting. "TINT" setting will show as below (right chart).

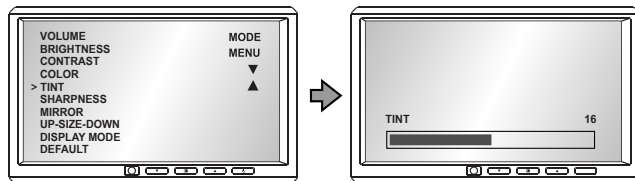

On-Screen-Display Settings:

SHARPNESS:

Press Menu button on remote or on control panel, OSD menu will show on LCD screen as below (left chart), press up/down button on remote or press up/down button on control panel to select "SHARPNESS" setting. "SHARPNESS" setting will show as below (right chart).

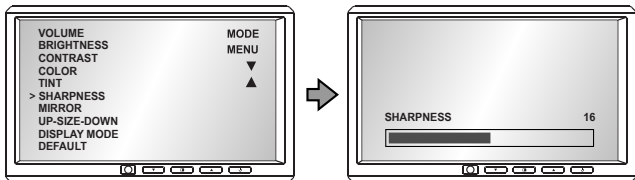

MIRROR:

Press Menu button on remote or on control panel, OSD menu will show on LCD screen as below (left chart), Set the display mode by pressing the image horizontal mirror or not. Good for car reverse monitoring system. Default is Off.

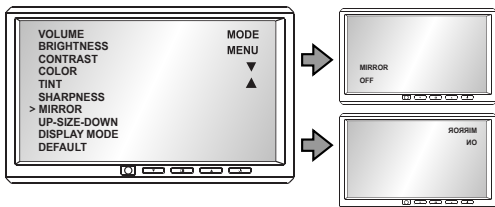

UP-SIZE-DOWN:

Press Menu button on remote or on control panel, OSD menu will show on LCD screen as below (left chart), Set the display mode by pressing the image vertical mirror or not. Good for car reverse monitoring system. Default is Off.

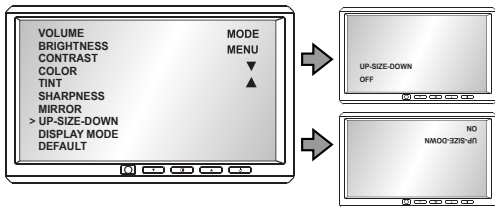

On-Screen-Display Settings:

DISPLAY MODE: (NORMAL / CINEMA)

Press Menu button on remote or on control panel, OSD menu will show on LCD screen as below (left chart), press up/down button on remote or up/down button on control panel to select "NORMAL" or "CINEMA" display mode. "DISPLAY" setting will show as below (right chart).

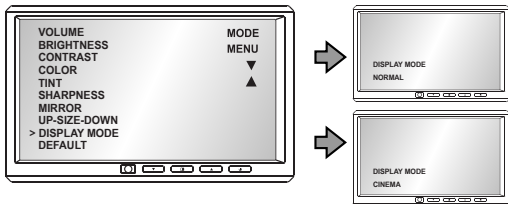

RESET :

Press Menu button on remote or on control panel, OSD menu will show on LCD screen as below (left chart), press up/down button on remote or up/down button on control panel to select "RESET" setting. "RESET" setting will show as below (right chart).

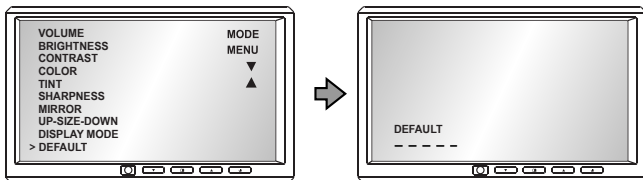

Installation Notes:

The Wide Screen Universal Monitor includes mounting options described in the following sections.

Before you install the monitor, consider the following important notices:

1. NEVER install this monitor where it can be viewed from the driving position; this is a violation of many state and local vehicle codes.
2. Avoid mounting locations where there is a risk of impact with a passenger in the event of an accident.
3. Always mount the monitor securely using the mounting hardware that is provided. Do not use the monitor unless it is properly secured to the vehicle.

Box Contents:

The Widescreen Universal Monitor includes the following parts and equipment:

1. Monitor
2. Remote Control
3. Bracket
4. Manual
5. Control Box and Power Cable
6. Monitor Extension Cable

TECHNICAL SPECIFICATIONS

Model No	In-Dash 7-inch Wide Screen Color Monitor
Monitor Display System	7-inch (18cm) Active Matrix Color LCD Display NTSC / PAL Automatic Select
Display Format	112,320 pixels
Aspect Ratio	16 : 9
Resolution	336,960 dots / 1,440 (W) x 234 (H) dots
Front Panel	Anti-glare glass
Active Area	154.08 (W) x 86.58 (H) mm
Back Light	20,000 hours normal operation
Source	Composite video input x 2 (Vp-p:0.8~1.2mV) Composite audio input x 2 (Vp-p:0.8~1.2mV)
Operating Voltage	DC 12V
Operating Current	0.5Amp (Nominal) ~0.75Amp (MAX)
Operating Temperature	-20° C to 80° C
Weight	0.3KG
Dimensions	172.6(W) X 110(D) X 29.4 (H) mm

Dimensions:

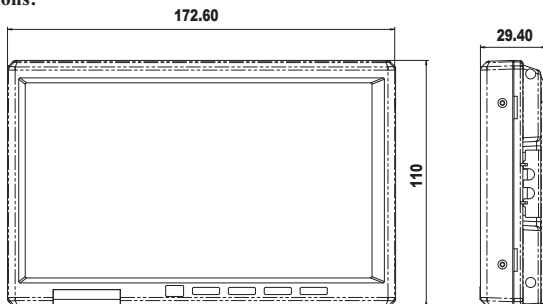

TECHNICAL SPECIFICATIONS

Model No	Control Box
Source	CCD Camera x 2
	Composite video input x 2 (Vp-p:0.8~1.2mV) Composite audio input x 2 (Vp-p:0.8~1.2mV) Composite video output x 2 (Vp-p:0.8~1.2mV) Composite audio output x 2 (Vp-p:0.8~1.2mV)
Operating Voltage	DC 12V~32V
Operating Current	0.5Amp (Nominal)
Operating Temperature	-20° C to 85° C
Weight	0.14KG
Dimensions	109(W) X 79.4(D) X 28 (H) mm

Dimensions:

